

SNK500

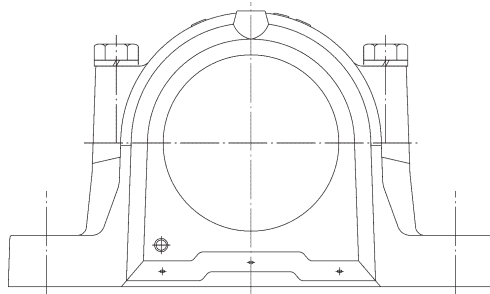

SN500/600/3000

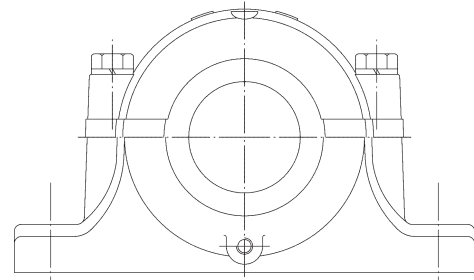

Material

Cast Iron, Ductile Iron & Cast Steel

Cast Iron, Ductile Iron & Cast Steel

Appropriate Bearing Series Mounting

12, 22, 13, 23, 222, 223
Adapter & Cylindrical

12, 22, 13, 23, 222, 223, 232, 213, 230
Adapter & Cylindrical

Shaft Size Range

3/4" ~ 5-1/2"

20mm to 140mm

3/4" ~ 6"

20mm to 200mm

Plummer Block Size

505-532

505-532 605-623 3024-3044 3122-3138

Lubrication



Standard Seals



TSNA

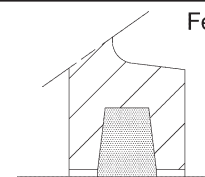

Felt seal (FS)

Optional Seals



U-LOK

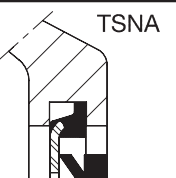

TSNA



ZF seal

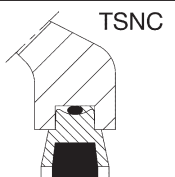

TSNC

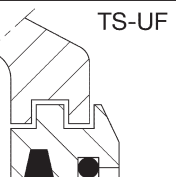

TS-UF

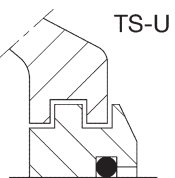

TS-U

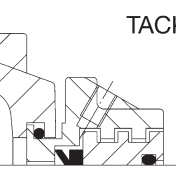

TACK

SSN500/600 FS / TS / TAC

SD3100FS / TS / TAC

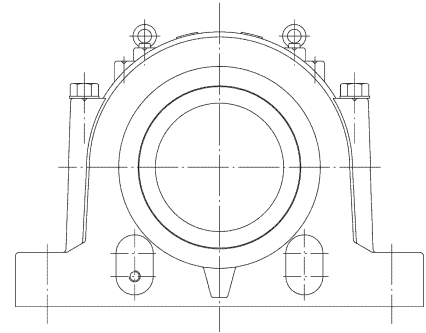
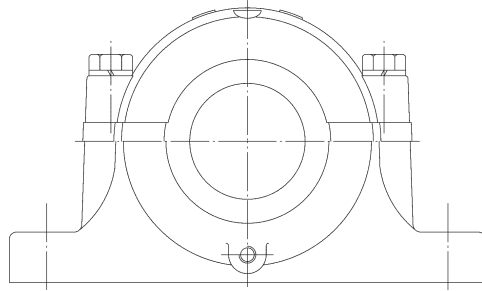

Material

Cast Iron, Ductile Iron & Cast Steel

Cast Iron, Ductile Iron & Cast Steel

Appropriate Bearing Series Mounting

12, 22, 13, 23, 222, 223
Adapter & Cylindrical

213
Adapter & Cylindrical

Shaft Size Range

3/4" ~ 6"

20mm to 150mm

3/4" ~ 13-15/16"

150mm to 380mm

Plummer Block Size

505-532 605-632

3134-3180

Lubrication



Standard Seals

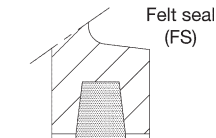

Felt seal (FS)

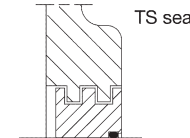

TS seal

Optional Seals



ZF seal

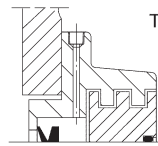

TAC-V seal

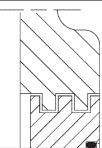

TS seal

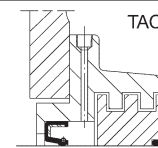

TAC-O seal

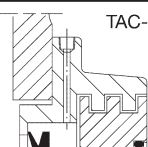

TAC-V seal

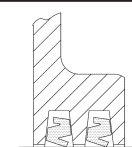

ZF seal

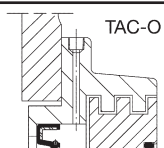

TAC-O seal

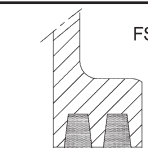

FS seal

SD500/600/3000

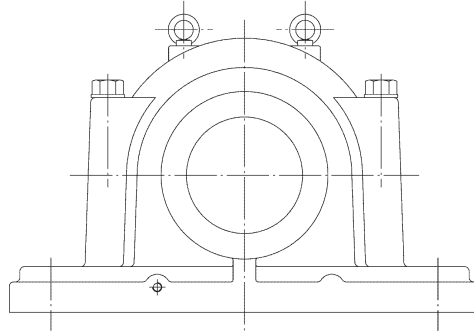

SAF500/600

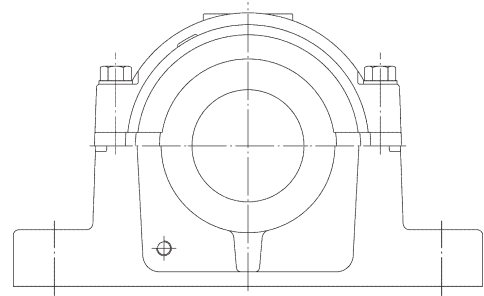

Material	Cast Iron, Ductile Iron & Cast Steel		Cast Iron, Ductile Iron & Cast Steel	
Appropriate Bearing Series Mounting	222, 223, 230 Adapter & Cylindrical		222, 223 Adapter & Cylindrical	
Shaft Size Range	-	150mm to 360mm	1-7/16" ~ 7-3/16"	-
Plummer Block Size	534-564 634-656 3034-3076		509-544 609-640	
Lubrication				
Standard Seals				
Optional Seals				

SDAF500/600/00K

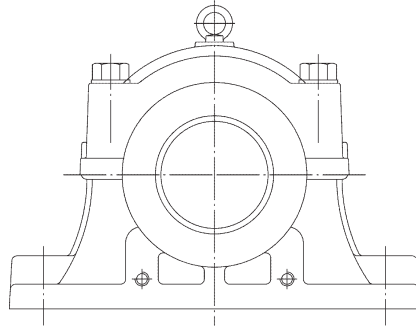

SNK3100/3000

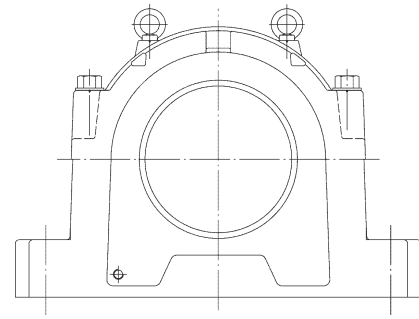

Material

Cast Iron, Ductile Iron & Cast Steel

Cast Iron, Ductile Iron & Cast Steel

Appropriate Bearing Series Mounting

222, 223, 230
Adapter & Cylindrical

213, 230
Adapter & Cylindrical

Shaft Size Range

3-7/16" ~ 14"

-

-

150mm to 450mm

Plummer Block Size

520-544 616-640 024K-076K

3134-3196

Lubrication



Standard Seals

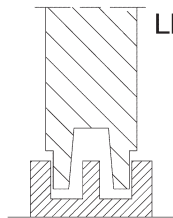

LER seal

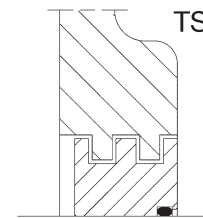

TS seal

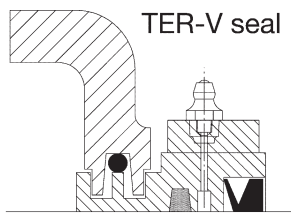

TER-V seal

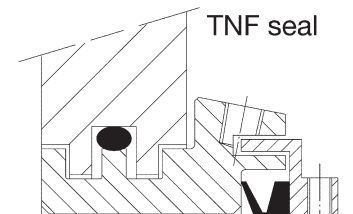

TNF seal

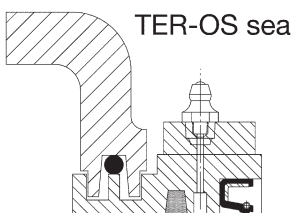

TER-OS seal

NOTES: SNK3100 (GREASE QUANTITIES)
Fills approximately 40% of the free space in the housing

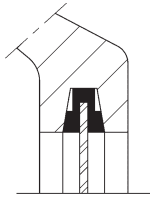

"NA" for SN type

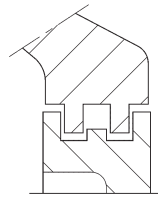

"TSA" for SD/SSN-TS types

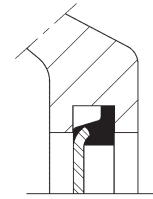

"A" for SNK & SNU types

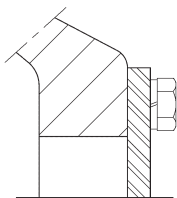

"P" for SD/SSN types
with taconite

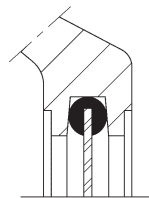

"EPR" for SAF/SDAF types



EP for SD & SAF048K-076K types

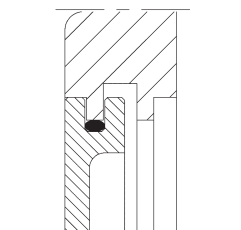

"ETS" for SNK3100 / 3000 types

For housings mounted at the ends of the shafts, the opening must be fitted with an end cover to prevent the entry of contaminants into the bearing.

I. Taconite seal for SSN/SD Housings (TAC)

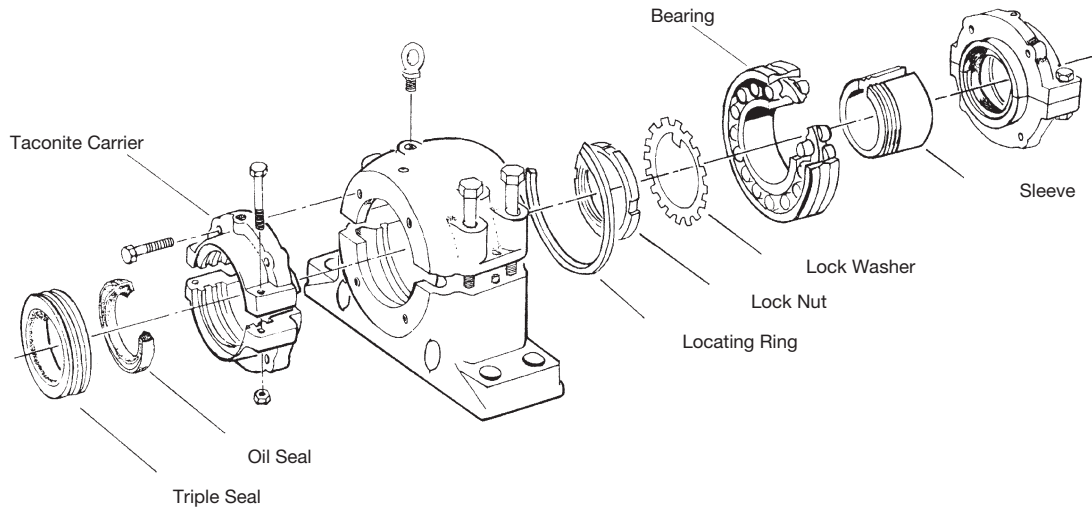

II. Inserted Type-Exclusively for SAF/SDAF Types (TER)

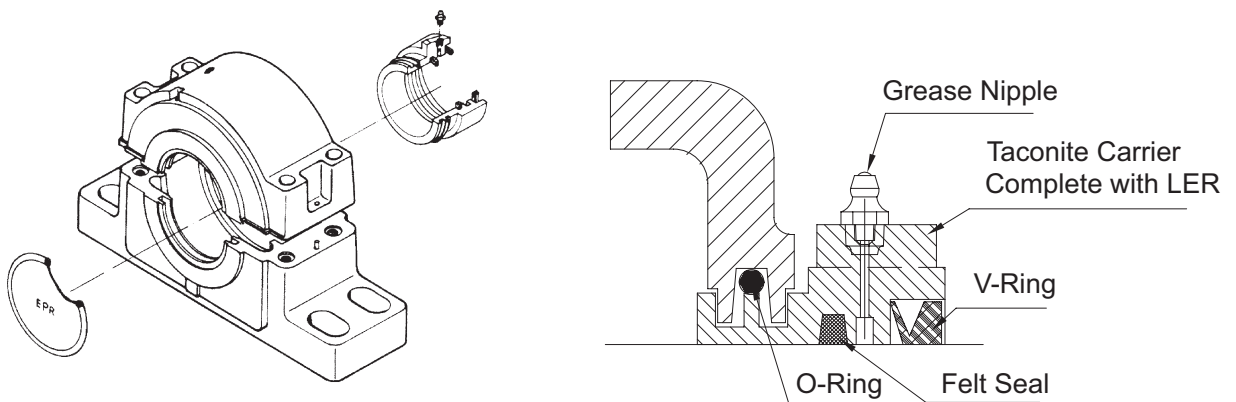

III. TACK - Kits 500 Series To Suit All SNK, SNN And SNH Type Housings.

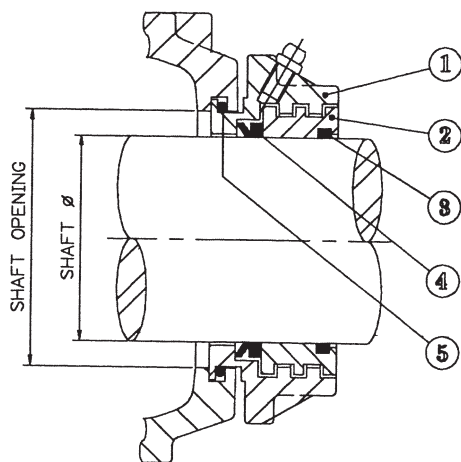

1	Split Carrier
2	Triple Seal
3	"O" Ring
4	"V" Ring
5	"O" Ring